

## Bramham House

A Vicar of Bramham , the Rev. Robert Bownas , clearly from a well - to - do background , built Bramham House in 1806 . Whether he and his wife Hannah [ there is a fine stained glass window memorial to her in the Church ] lived there or not , they sold the house and grounds in 1814 to James Fox of Bramham Park for £ 3000. James Fox gave the estate to his son George Lane Fox as a wedding present . In addition he engaged John Bellerby “ Upholsterer , Cabinet - Maker , Appraiser and Undertaker “ of Micklegate , York to value furniture obviously purchased from Rev. Bownas , and to supply , between Nov. 1814 and Feb. 1815 , furniture and fittings at a cost to James of £418 . 8 .9 . The bill was paid 3 months later on 11 May 1815.

Unfortunately , son George ‘ s time as head of the family contrived to place them into considerable debt after the death of his father in 1821. His inveterate gambling [ he is still referred to as George the Gambler ] , together with the large sums which James had spent to provide for his widow and younger children and those George had to settle on his own daughters , proved an enormous drain . These, with mounting expenses and interest on unpaid loans , meant that by the time of his death in 1848 , the estate was in debt to the tune of £232 , 799.

Though he had moved from Bramham House to The Park on inheriting in 1821 , it was only 7 years before he was back , when The Park was gutted by fire in July 1828. Bramham House then continued as a substitute family seat until “ Gambler “ George bought and moved to Bowcliffe Hall in 1841, and it remained in the family until his son “ Squire ” George sold it in 1856 as he began his successful campaign to retrieve



the family fortunes.

2

During the next 70 years , Bramham House had a succession of owners. John R. Gregson bought it initially from the Lane Foxes in 1856 [ he also owned property at Burdon , Durham ] , and was living there according to Kelly 's Directory in 1867 . It was then sold to a Captain Preston , who in turn sold the estate to Charles Stuart Robson J.P. around the turn of the century . Certainly , at both the 1901 and the 1911 Censuses , Mr. Robson was resident , but he sold the estate around 1914 to Major John Lister Ingham of Wighill.



The old stables behind the Fire Station





Bramble House. See book page 97.



Derelict during the first half of the 1990's,  
after the Leeds Alkali's had closed.



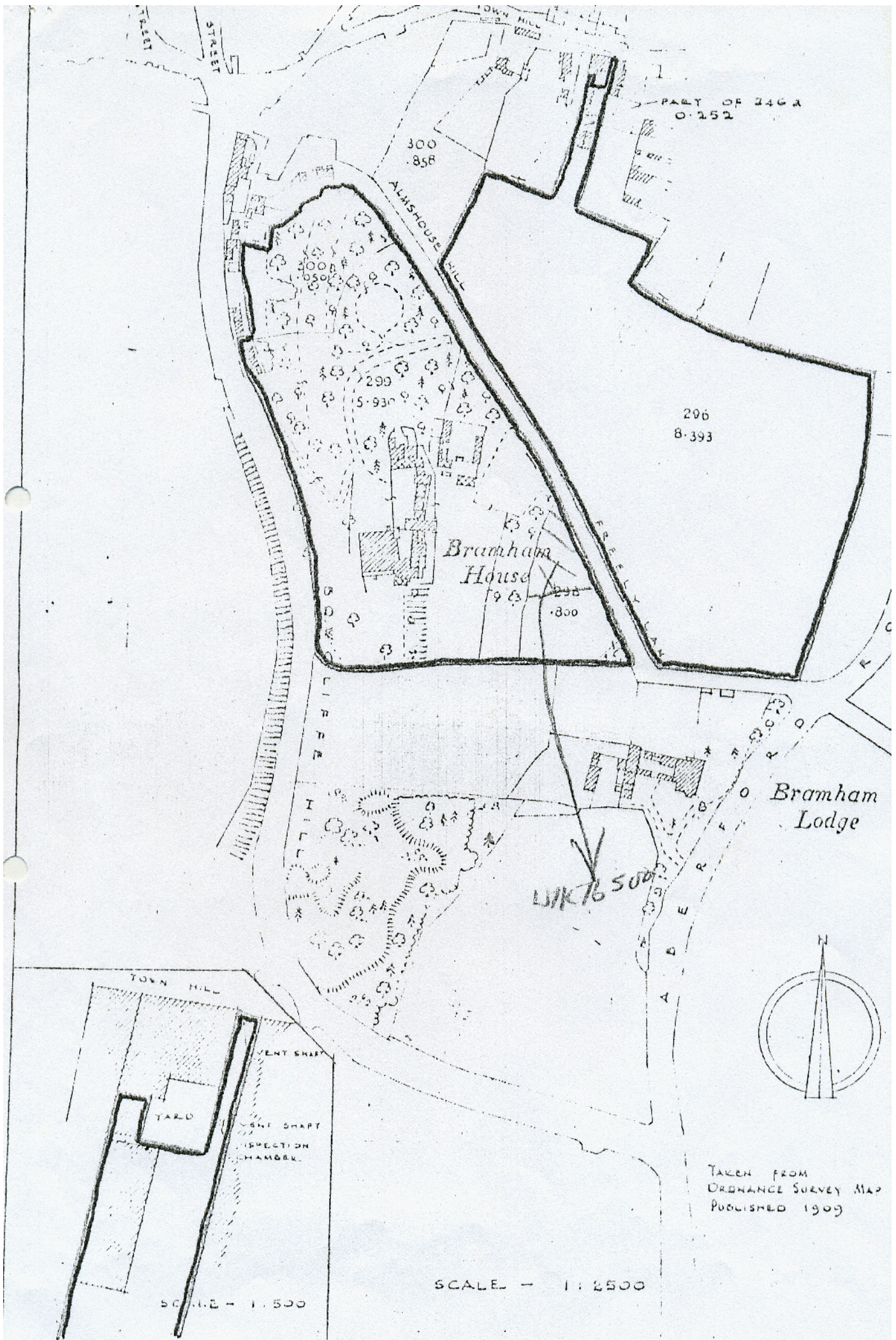



# Plan referred to

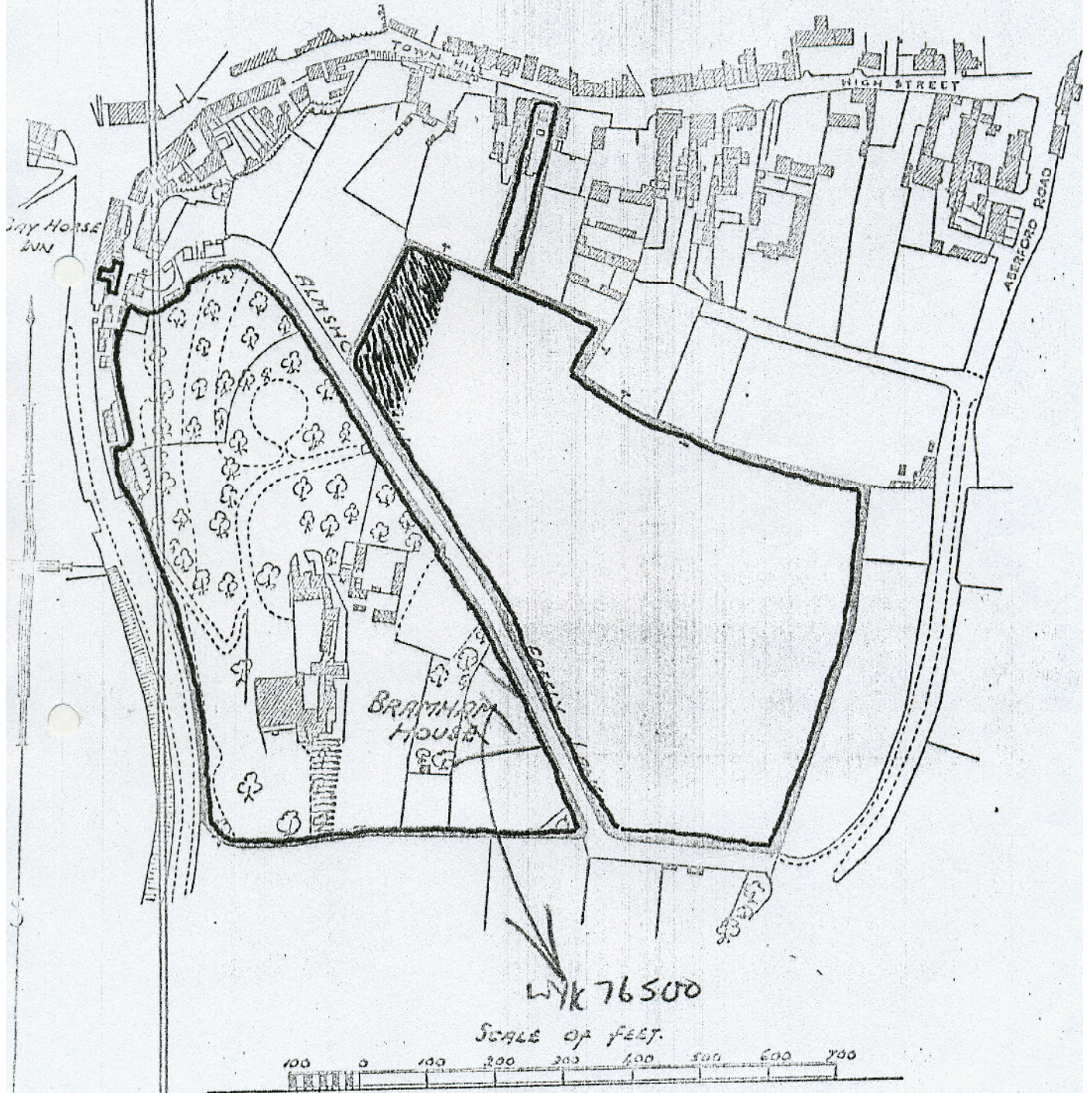

JACKSON AND FOX SURVEYORS, HALIFAX.  
OCTOBER, 1924.





THE FAMILY OUTSIDE THE STABLE BLOCK *Compton Talbot*  
WHERE THE AMBULANCE STATION STANDS.  
SOLD BY THE WIDOW (1948) TO WEST RIDING C.C.  
AND CONVERTED INTO A CHILDRENS' HOME. A NEW  
CONCEPT OF CHILD CARE UNDER 1948 CHILDREN'S ACT.





THE RAMSDEN FAMILY

*Compton Talbot*

SON ROBERT, CAPTAIN RAMSDEN (FATHER) WIFE,  
AND DAUGHTERS BETTY AND JANET.

FATHER DIED WHEN OUT SHOOTING - ROBERT A FEW  
YEARS LATER - KILLED ON HIS MOTOR CYCLE NEAR  
RISTON.



## **BOWCLIFFE ROAD, BRAMHAM**

**Under Policy H4(52), 2.0 ha of land is allocated for housing at Bramham House, Bramham, subject to:**

- i. RETENTION OF MATURE TREES (SUBJECT TO DETAILED TREE SURVEY);**
- ii. PROVISION OF SUITABLE ACCESS FROM FREELY LANE AND/OR BOWCLIFFE ROAD;**
- iii. RETENTION OF BRAMHAM HOUSE;**
- iv. PROVISION, WHERE NECESSARY, OF NOISE ATTENUATION MEASURES GIVEN THE PROXIMITY OF THE A1;**
- v. PROVISION OF AMENITY SPACE ON THE EASTERN SIDE OF THE SITE**

Recent improvements to the A1 allow a large area of land to the south of the existing village to be released from the Green Belt and located within the Conservation Area. Only part of this area is allocated for housing. Bramham House, a former children's home, is located to the east of Bowcliffe Road and is set within mature trees, many of which are worthy of retention. The former children's home building, whilst not listed, is within the Conservation Area and considered worthy of retention. In the context of Policy N19, the conversion of the buildings with some sensitive development in the grounds would form an appropriate extension to the village.

*Extract from final version of Leeds UDP  
adopted. 1 Aug. 2001*